



## SL6000 Passenger Lift



**XJ | Schindler**





# SL6000 Passenger Lift

Integration of European elevator system design, efficient power design, and new car humanistic design, whole combined with Building Safety technology platform, equipped with standby energy saving technology, more comfortable whe take the lift, more leisurely, more environmentally friendly.



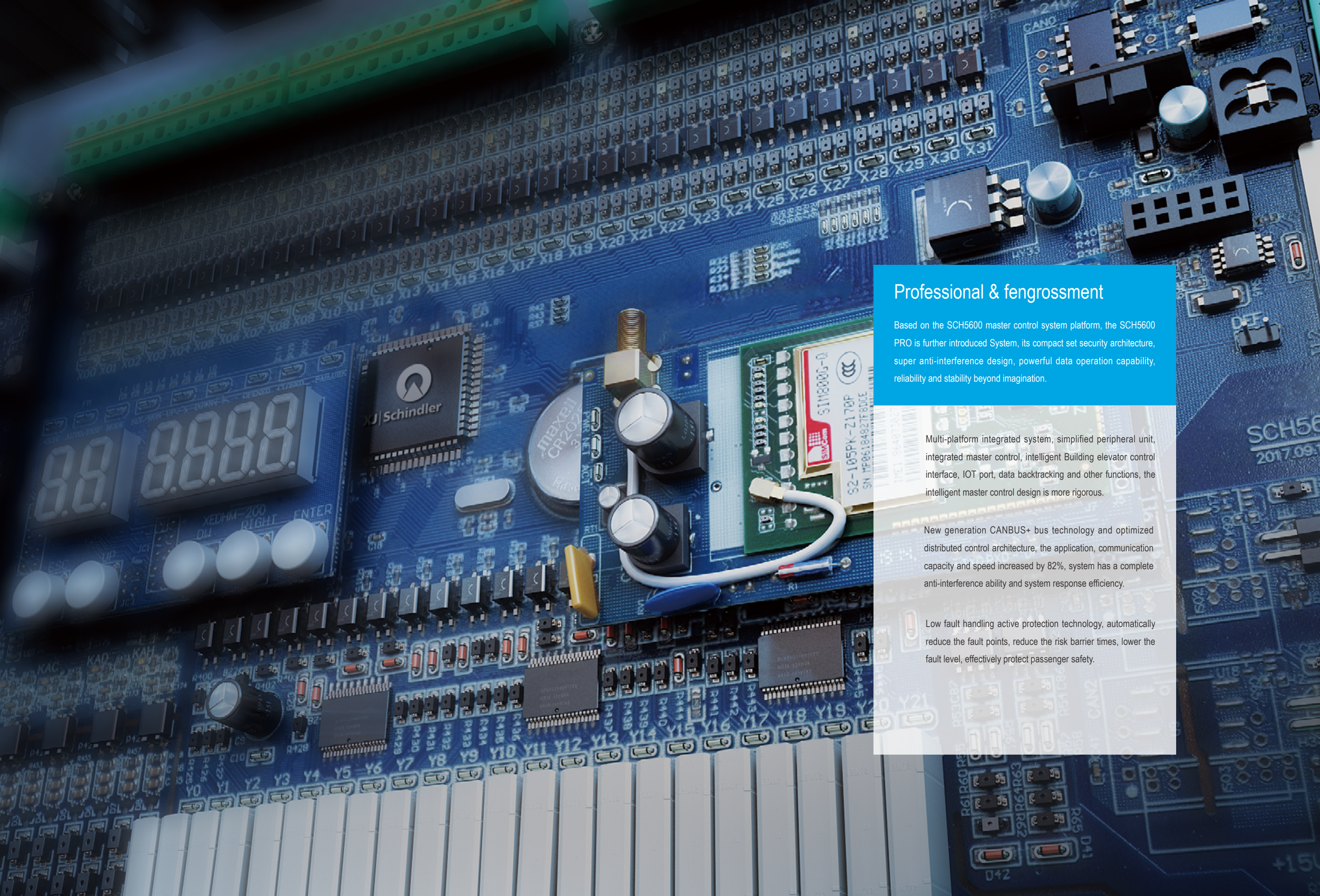

# Professional & fengrossment

Based on the SCH5600 master control system platform, the SCH5600 PRO is further introduced System, its compact set security architecture, super anti-interference design, powerful data operation capability, reliability and stability beyond imagination.

Multi-platform integrated system, simplified peripheral unit, integrated master control, intelligent Building elevator control interface, IOT port, data backtracking and other functions, the intelligent master control design is more rigorous.

New generation CANBUS+ bus technology and optimized distributed control architecture, the application, communication capacity and speed increased by 82%, system has a complete anti-interference ability and system response efficiency.

Low fault handling active protection technology, automatically reduce the fault points, reduce the risk barrier times, lower the fault level, effectively protect passenger safety.



SL6000 Building Safety Security technology platform



Door area security protection  
No worry about falling or shearing accidents

When the car moves suddenly when the door is open, the system proactively protects the safety of passengers in advance and quickly stops the car to prevent shearing or sliding accidents.  
Invention patent No:ZL 2016105772106



Absolute position control  
Solve the phenomenon of elevator split-level disorder  
  
The system monitors the elevator operation in real time, calculates the car position and elevator operation data, and protects the safety of passengers intelligently.

Non-leveling area security protection  
Avoid the accident of forcing the door and falling into the shaft  
  
In the non-leveling area, the system protection device actively locks the car door and keeps the passengers in a safe place.  
Invention patent No:ZL 2016102257211

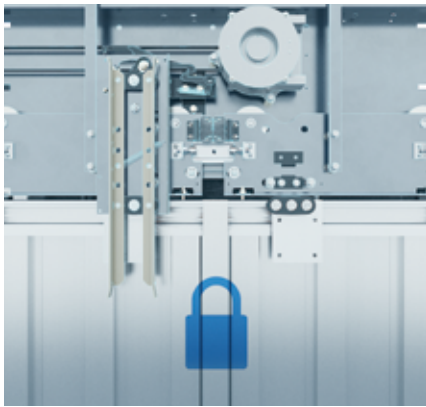

AX530 expert analysis system  
Greatly reduce the fault, scientific realization of the fault does not trap passengers.  
  
Real-time analysis of elevator data, automatically distinguish safety and non-safety fault types, scientific realization of the fault is not trap passengers.



VDI 4707 Energy performance Certificate  
Issued by- LIFTINSTITUUT

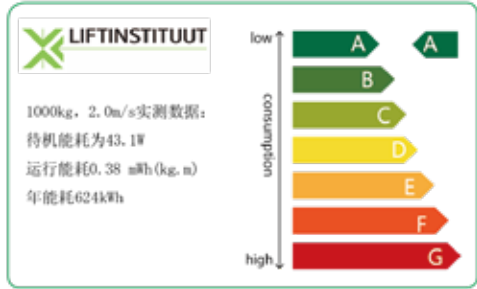

Standby energy saving technology  
We reduce wasted elevator standby power consumption by 52%

Realize the seamless conversion of electric energy between working and non-working states. When no one takes the elevator, the elevator enters the standby state, and the standby power consumption is less than 50W; When someone calls, the elevator wakes up immediately to resume normal operation.



eCloud Elevator management  
Escort your travel safely  
  
Monitor the elevator operation status and maintenance progress, problems are found in real time and solved quickly, to ensure timely and efficient maintenance, greatly improve management efficiency and after-sales quality.  
Software copyright:2019SR0550068 2019SR0551071





## More rigorous- more efficient

Based on Power X technology platform and XJ Schindler Efficient Dynamics achieves the true combination of dynamics and efficiency, excellent power transmission and carrying capacity, and ensures the comfort of the elevator safe and reliable.

The modular stator technology greatly improves the flux efficiency and makes the traction transport. The output power is greatly increased to ensure the high efficiency and full load output of the tractor, and effectively reduce vibration and magnetic leakage.

The design of high load bearing characteristics effectively reduces the abnormal vibration or noise of the elevator sound, run more smoothly.

Optimized design of traction sheave groove, low load loss, improved ride comfort, extend wire rope life.

Real simulation of the actual conditions of the traction machine, 100% full load test to ensure production outgoing quality.





### Digital docking technology, comfortable and smooth start and stop

By using vector control and load compensation starting technology, through distance control, efficient and reliable digital direct docking is realized, speed curve is generated in real time, greatly reducing the starting and braking time, and providing excellent starting and stopping comfort.

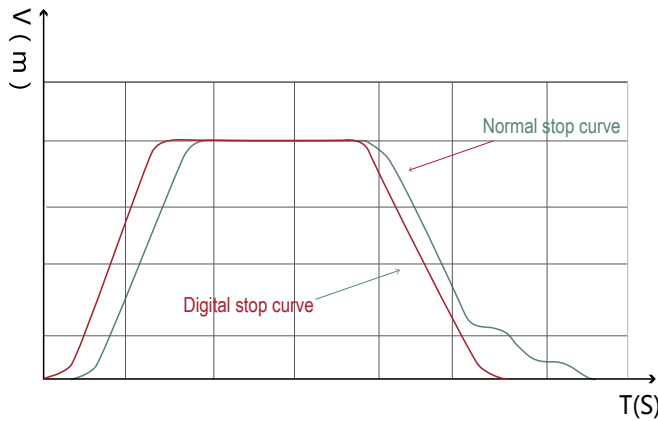

Digital docking operation curve diagram

### Sine wave servo door operator, opening and closing smoothly, efficient and reliable

Integrating the advantages of servo door motor, angular speed and angular displacement sensor, synchronous door cutter and synchronous drive match to form a new high-performance mechatronic direct drive door machine, to achieve accurate closed-loop control of speed, position and torque, the running curve of the door is not affected by the load, and the whole process of opening and closing action is self-adaptive, smooth, flexible and efficient.

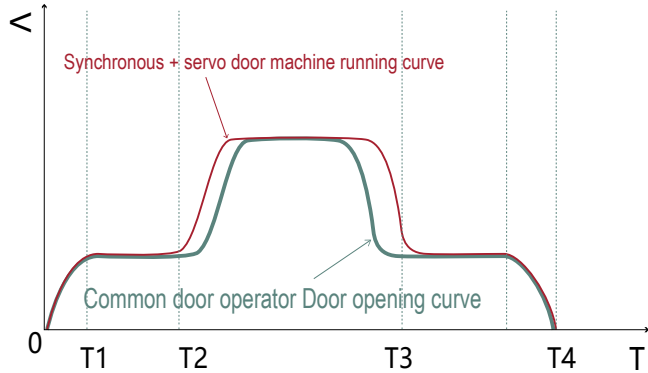

Door open & running curve diagram



## 越人文，越世界

Aseptic car design, adding negative ion device, automatic ventilation system, big ventilation, car air fresh and natural health. \*

Integration of low noise traction machine design, car wall noise reduction technology, operating system noise reduction design, elevator operating noise to 43dB.

Comfortable lighting illumination design, elegant and harmonious.

The open and comfortable car height and space environment create a more comfortable public exclusive ride environment.

\* The negative ion device is optional



# Mature and perfect no room technology

## Unique double suspension structure

Greatly improve the utilization of shaftl space, more freedom to architects for design, save construction costs for builders, and be more suitable for many building structures.

## Symmetrical balancing suspension system, smooth and comfortable

XJ Schindler proprietary technology makes the guiding center, hanging center and the center of gravity of the car fully coincide, greatly reducing the vibration and noise generated during operation, providing a more superior ride experience.

## Specially MRL main control system

- XJ Schindler launched a dedicated roomless control system, optimized control algorithm and data structure, greatly improved command operation speed, with more excellent stability and efficiency.
- Simplify the components of the main control system, reduce the wiring of the main control system by 23%, so that the degree of system integration and modularity are greatly improved, and the installation and debugging are more convenient.
- Eliminate the redundant parts of the main control system, reduce the main fault sources during the system operation, and significantly improve the reliability of the system operation.

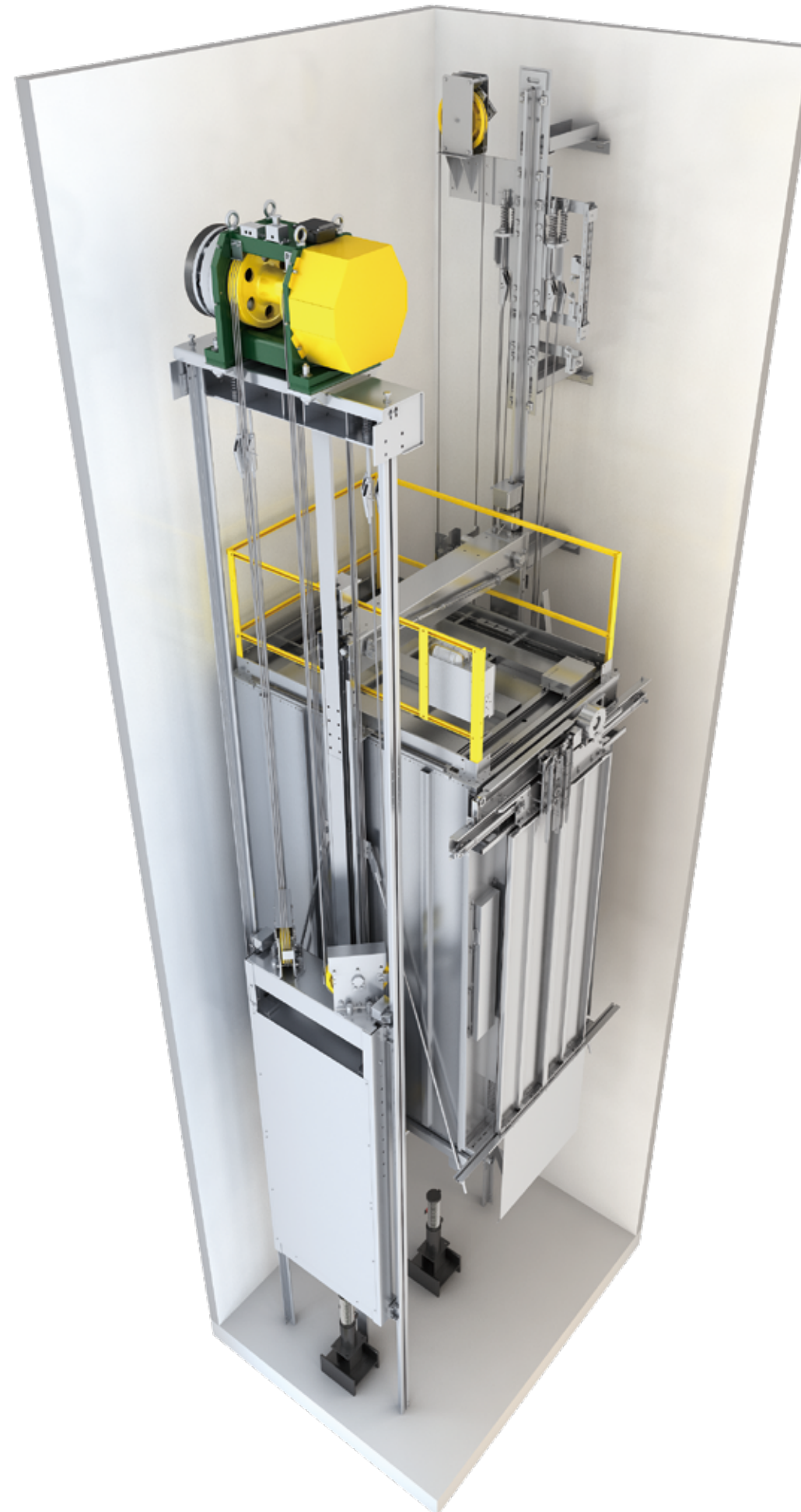

## Unique traction system

Specially designed for the non-machine room two-wheel tractor system, greatly saving well space, excellent performance, more powerful power.

## Superior performance door system

Optimized and upgraded door engine system, large margin opening and closing torque design, effectively improve the reliability and stability of the door engine system.

## Super slipway operating system

With super slide running system, using high-performance guide boots and wear-resistant shoe lining, self-priming oil box, smooth running, moderate oil, no oil, more environmentally friendly.

## Vibration isolation reduces noise30%

Unique vibration isolation technology, the tractor is placed in a special position and isolated from the car, vibration guide to the ground, noise reduction by 30%, reduce the noise pollution of operation, and create a quiet riding environment for passengers.





XS01

Car wall panel	Powder coating
Flooring	Wear-resist
Car door panel	Powder coating
Front return panel	Powder coating
False ceiling	X72C
Indicator	Text LCD

Note:This picture is a digital simulation, ordering refer to the actual subject



XS02

Car wall panel	Hairline S.S
Flooring	Wear-resist
Car door panel	Hairline S.S
Front return panel	Hairline S.S
False ceiling	X56C
Indicator	Text LCD

Note:This picture is a digital simulation, ordering refer to the actual subject





XS03	
Car wall panel	Powder coating
Flooring	Wear-resist
Car door panel	Hairline S.S
Front return panel	Hairline S.S
False ceiling	X72C
Indicator	Text LCD

Note:This picture is a digital simulation, ordering refer to the actual subject



XS04	
Car wall panel	3-side Hairline S.S + etching SS
Flooring	Wear-resist
Car door panel	Hairline S.S
Front return panel	Hairline S.S
False ceiling	X12C
Indicator	Text LCD

Note:This picture is a digital simulation, ordering refer to the actual subject





JX03

Car wall panel	Hairline S.S + Mirrow S.S. of rear midle wall
Flooring	Wear-resist
Car door panel	Hairline stainless steel
Front return panel	Hairline stainless steel
False ceiling	X72C
Handicap COP	ZZP-22 (Optional)
Indicator	Text LCD

Note:This picture is a digital simulation, ordering refer to the actual subject



JX11

Car wall panel	3-side Mirrow S.S + etching SS
Flooring	Wear-resist
Car door panel	Hairline S.S
Front return panel	Hairline S.S
False ceiling	X76C
Indicator	Text LCD

Note:This picture is a digital simulation, ordering refer to the actual subject



# Passenger lift with rescue

Customized rescue lift for residential buildings and public places, reliable rescue system design, scientific car space planning, to facilitate emergency rescue, without obstacles to quickly reach the destination floor.

Special space design, more suitable for stretcher access

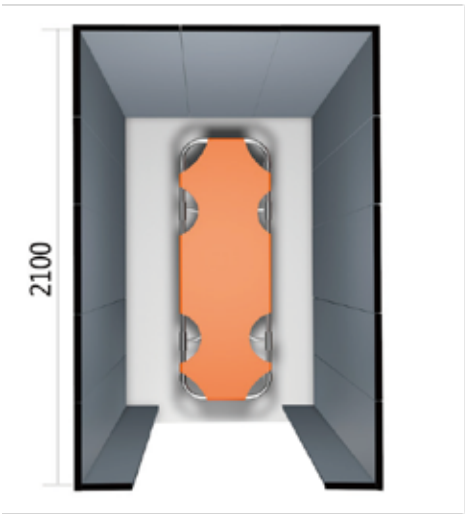

Large depth space design

Counterweight located shaft sideways, focus on the depth of the car design, Max depth to 2100mm, convenient for the rescue stretcher directly in and out.

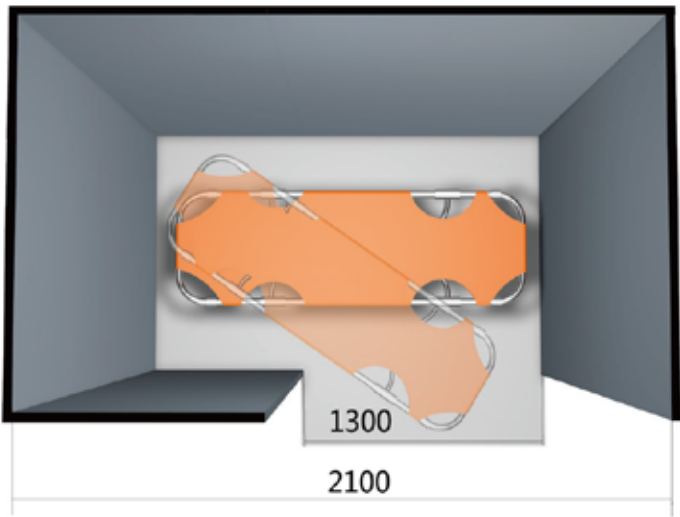

Large door width space design

Counterweight located shaft rear side, widen the car design and max width to 2100mm, increase the door width to 1300mm, especially suitable for the side access of the stretcher.

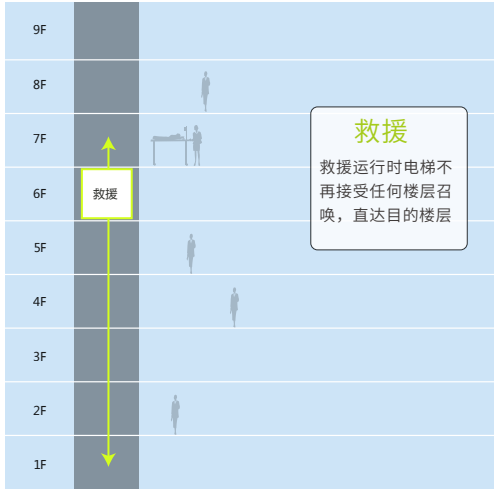

## Dedicated rescue system \*

Direct delivery function: When the "rescue" function is activated, the elevator will no longer accept other call requests, forming a fast dedicated direct channel, reaching the destination floor in the shortest time, and the system will automatically resume normal use after the completion of the task.

## Power failure emergency operationdevice \*

For rescure, lift can deploed emegency operation device; once power failure, this emegency device start to work and let the lift to leveling at nearest floor, release the trapped passengers.



## Rescue lift-01

Car wall panel	Hairline S.S
Flooring	Wear-resist
Car door panel	Hairline S.S
Front return panel	Hairline S.S
False ceiling	X75C

Indicator	Text LCD
-----------	----------

Note:This picture is a digital simulation, ordering refer to the actual subject

\* Note: Optional functions for rescue system & power failue emergency operation device





Features

Swing COP CZP-22(Standard)



Car operating indicator

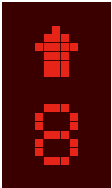

LED dot matrix  
(Optional)



Text LCD  
(Optional)



TFT True color  
(Optional)



TFT picture display  
(Optional)



Multimedia audio-visual  
(Optional)



TFT picture display  
(Optional)



Multimedia audio-visual  
(Optional)

Handicap COP ZZP-22(Optional)



Indicator above entrance(Optional)



Text LCD



LED Dot matrix



Ultrathin LOP

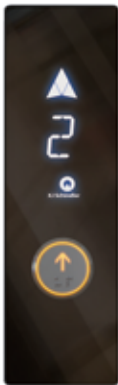

HT-21

Handrail (optional)



FS-11WJ Stainless steel - U shape



FS-WFB Flast in hairline stainless steel



FS-11J Stainless steel - Straight

Hall lanterns(optional)



DZD-JF  
Square shape crystal  
Mirror stainless steel

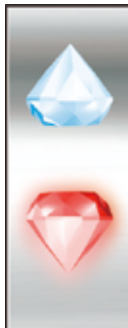

DZD-JS  
Diamond shape crystal  
Mirror stainless steel

False ceiling



X12C



X72C



X76C



X56C



X75C Scope:Rescue-used lift



M17C Scope:Rescue-used lift

Flooring



DM-A15



DM-A16

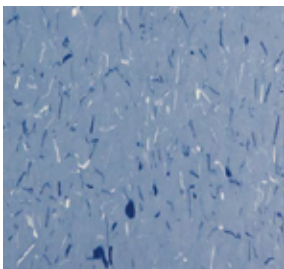

DM-A17

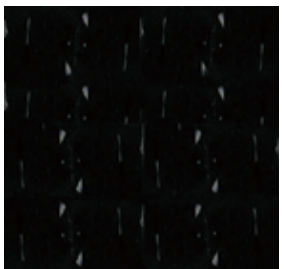

DM-A25

Car wall panels



Power coat - Jazz silver



Hairline stainless steel

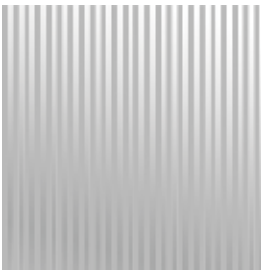

Etched stainless steel



Mirror stainless steel



SL6000 MR lift layout drawings

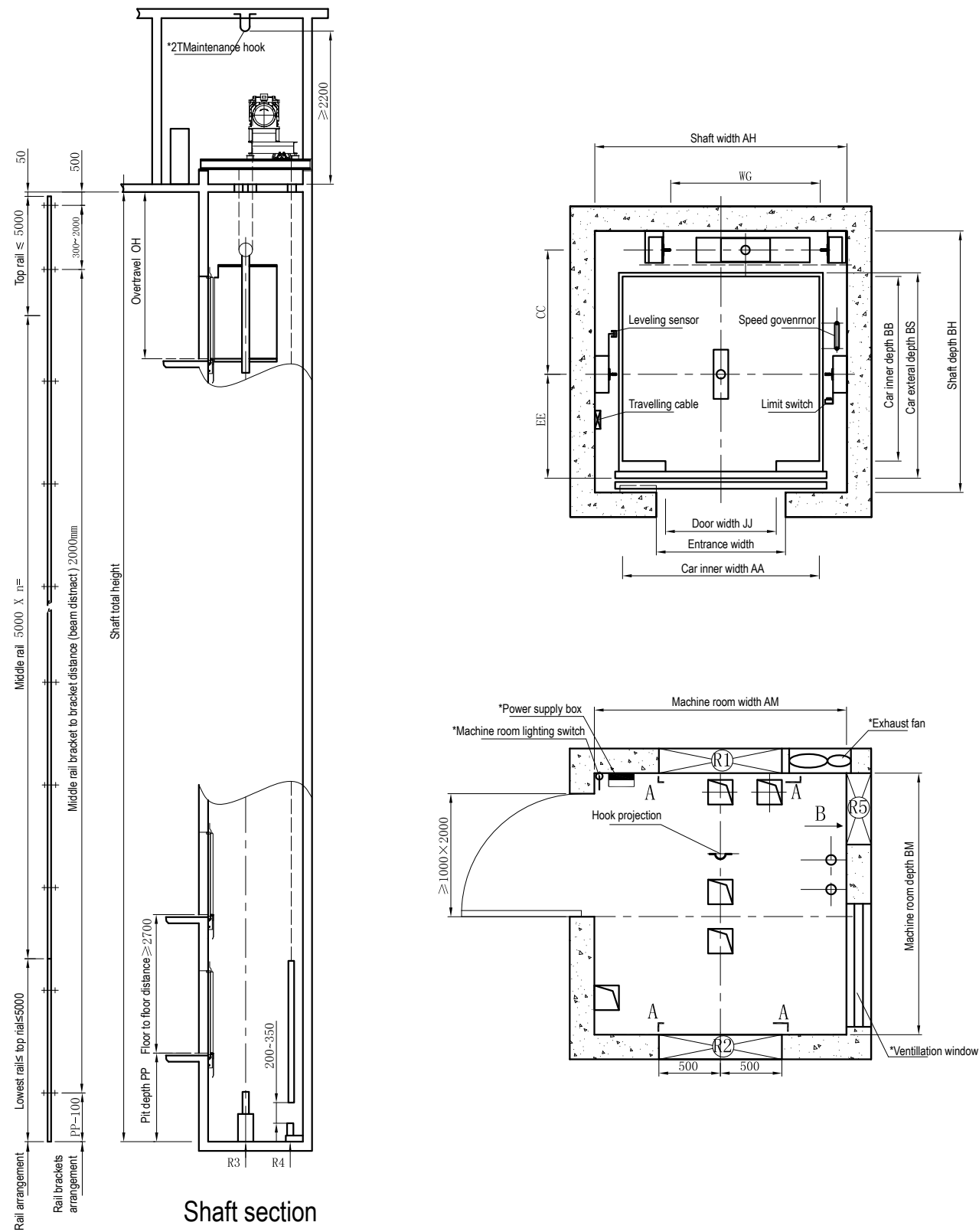

SL6000 MR lift specifications

Model	Speed m/s	Load kg	Door opening width JJ	Door opening depth	Car size AAxBB	Shaft size AHxBH	MR size AMxBM	Pit depth PP	Overtravel OH	MR net height below hoisting hook HM
SL6000	1.0	630	800	950	1400x1100	1850x1700	1850x1700	1400	4200	2200
SL6000	1.5							1400	4300	2200
SL6000	1.75							1400	4400	2200
SL6000	1.0	800	800	950	1400x1350	1850x1950	1850x1950	1400	4200	2200
SL6000	1.5							1400	4300	2200
SL6000	1.75							1400	4400	2200
SL6000	2.0							1500	4800	2200
SL6000	2.5							1900	5000	2200
SL6000	2.5							1900	5000	2200
SL6000	1.0	1000	900	1050	1600x1500	2050x2150	2050x2150	1400	4200	2200
SL6000	1.5							1400	4300	2200
SL6000	1.75							1400	4400	2200
SL6000	2.0							1500	4800	2200
SL6000	2.5							1900	5000	2200
SL6000	2.5							1900	5000	2200
SL6000	1.0	1150	1100	1250	2000x1350	2500x2000	2500x2000	1400	4200	2200
SL6000	1.5							1400	4300	2200
SL6000	1.75							1400	4400	2200
SL6000	2.0							1500	4800	2200
SL6000	2.5							1900	5000	2200
SL6000	2.5							1900	5000	2200
SL6000	1.0	1350	1100	1250	2000x1500	2500x2150	2500x2150	1400	4200	2200
SL6000	1.5							1400	4300	2200
SL6000	1.75							1400	4400	2200
SL6000	2.0							1500	4800	2200
SL6000	2.5							1900	5000	2200
SL6000	2.5							1900	5000	2200
SL6000	1.0	1600	1100	1250	2000x1750	2500x2400	2500x2400	1400	4200	2200
SL6000	1.5							1400	4300	2200
SL6000	1.75							1400	4400	2200
SL6000	2.0							1500	4800	2200
SL6000	2.5							1900	5000	2200
SL6000	2.5							1900	5000	2200

Civil installation requirements ( by archtecture)

Shaft requirements

- 1.Shaft walls shall be of concrete, reinforced brick or steel construction to withstand the required load.
- 2.Leave holes on the wall of each floor (for installing landing doors, indicators and hall call boxes), and decorate the exterior wall and floor by the user after the elevator is installed.
- 3.Reserve steel bars for landing door jambs.
- 4.For the waterproof treatment of the bottom pit and the concrete pouring after the installation of the bottom pit buffer, there must be no open water and no leakage.
- 5.When the distance between two adjacent landing doors exceeds 11m, reserve inspection access doors.

Equipment room requirements

- 1.Reserve holes and waterproof platform on the floor of the equipment room.
- 2.Install lifting hooks on the ceiling of the equipment room that meet the requirements of the elevator builder.
- 3.Responsible for the concrete bearing table and embedded steel plate for supporting the steel beam of the traction machine on the ground of the machine room.
- 4.Responsible for laying and threading of power and lighting power from the power distribution room to the machine room.
- 5.Monitoring and laying of cables from the equipment room to the monitoring room of the five-way communication equipment.
- 6.Install the lighting and single-phase AC220V10A three-hole power socket in the equipment room. (Min. illumination in the equipment room at least 200Lx) Environment and power source.
- 1.The temperature in the equipment room required from 5 ° C to 40 ° C.
- 2.Relative humidity in the equipment room: ≤ 85% (at 25 ° C).
- 3.Be responsible for setting up exhaust fans and ventilation windows to maintain air circulation.
- 4.Main power supply: three-phase AC 380V 50Hz (three-phase five-wire system), voltage fluctuation within 7%.
- 5.Lighting power supply: single-phase 220V 50Hz (lighting power supply and main power supply should be laid separately).
- 6.Altitude: 3000m (if more than 3000m, please check with factory in advance).
- 7.The ground cable adopts the three-phase & five-wire grounding mode, and do ensure the neutral wire and the ground wire are separated (the ground resistance of the ground wires≤4 ohms).



SL6000 MRL PASSSENGER LIFT STANDARD LAYOUT DRAIWSG(≤1000kg)

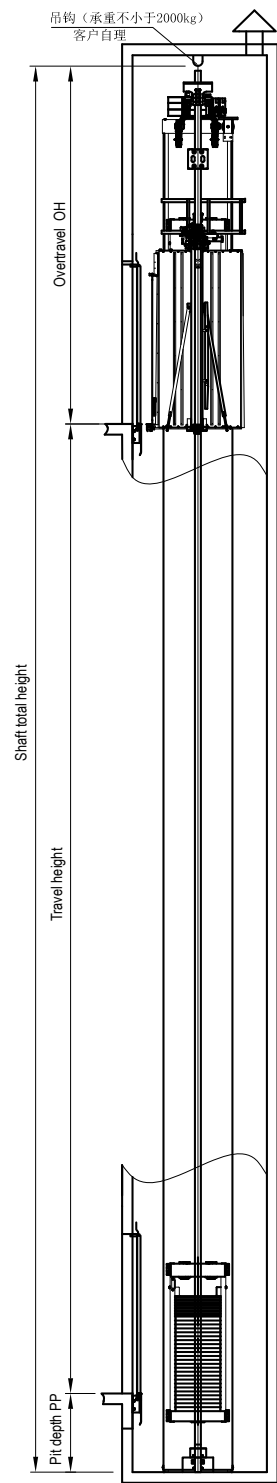

Shaft section

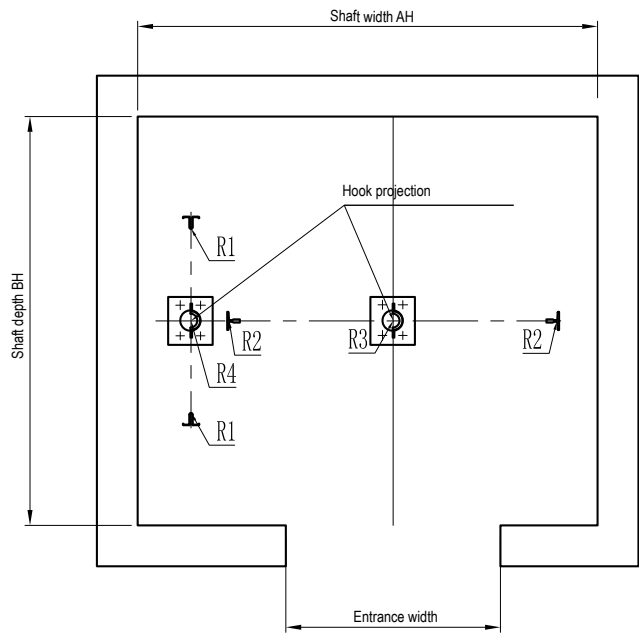
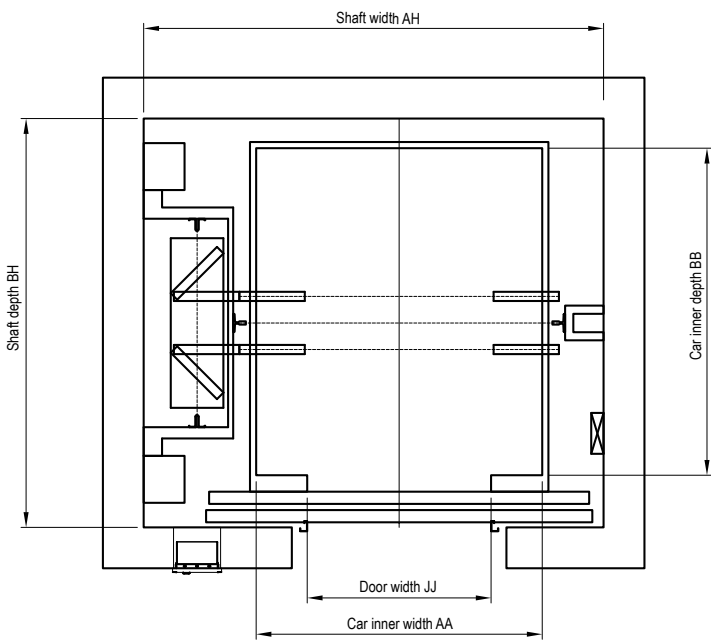

SL6000MRL lift specification

Model	Speed m/s	Load kg	Door opening width JJ	Entrance width	Car size AAxBB	Shaft size AHxBH	Pit depth PP	Min.Overtravel OH
SL6000	1.0	630	800	950	1100x1400	1950x1750	1600	3900
SL6000	1.5						1700	4100
SL6000	1.75						1800	4200
SL6000	1.0	800	800	950	1300x1500	2050x1900	1600	3900
SL6000	1.5						1700	4100
SL6000	1.75						1800	4200
SL6000	1.0	1000	900	1050	1400x1600	2200x2000	1600	3900
SL6000	1.5						1700	4100
SL6000	1.75						1800	4200
SL6000	1.0	1150	1100	1250	1400x1800	2600x2300	1800	4500
SL6000	1.5						1800	4800
SL6000	1.75						1800	5000
SL6000	1.0	1350	1100	1250	1400x2100	2600x2600	1800	4500
SL6000	1.5						1800	4800
SL6000	1.75						1800	5000
SL6000	1.0	1600	1100	1250	1400x2400	2600x2800	1800	4500
SL6000	1.5						1800	4800
SL6000	1.75						1800	5000

Civil installation requirements ( by architecture)

Shaft requirements

- 1.Shaft walls shall be of concrete, reinforced brick or steel construction to withstand the required load.
- 2.Leave holes on the wall of each floor (for installing landing doors, indicators and hall call boxes), and decorate the exterior wall and floor by the user after the elevator is installed.
- 3.Reserve steel bars for landing door jambs.
- 4.For the waterproof treatment of the bottom pit and the concrete pouring after the installation of the bottom pit buffer, there must be no open water and no leakage.
- 5.When the distance between two adjacent landing doors exceeds 11m, reserve inspection access doors.

Environment and electricity

- 1.The closed shaft shall be provided with ventilation holes as required (generally at the top and bottom of the shaft), the area shall not be less than 1% of the horizontal area of the well, and the ventilation holes shall be provided with protective nets.
- 2.Set the independent power supply for the elevator according to the requirements in the technical parameter table: the power supply needs to be equipped with a protected switch and locked, the voltage fluctuation  $\leq \pm 7\%$ , the ground wire adopts three-phase & five-wire grounding mode, the neutral line of the power supply and the ground line should be separated, and the grounding resistance value is  $\leq 4\Omega$ , and pull the power supply to the top floor.
- 3.The user shall set up a rescue duty room and lay a 6-core cable (shielded/twisted pair is recommended) to the top floor emergency operation panel side, cable size at least 0.75 mm<sup>2</sup> per core.
- 4.Main power supply: three-phase AC 380V 50Hz (three-phase & five-wire system), voltage fluctuation range within 7%.
- 5.Lighting power supply: single-phase 220V 50Hz (lighting power supply and mian power supply should be laid separately).
- 6.Altitude: 3000m (if more than 3000m, please check with factory in advance).



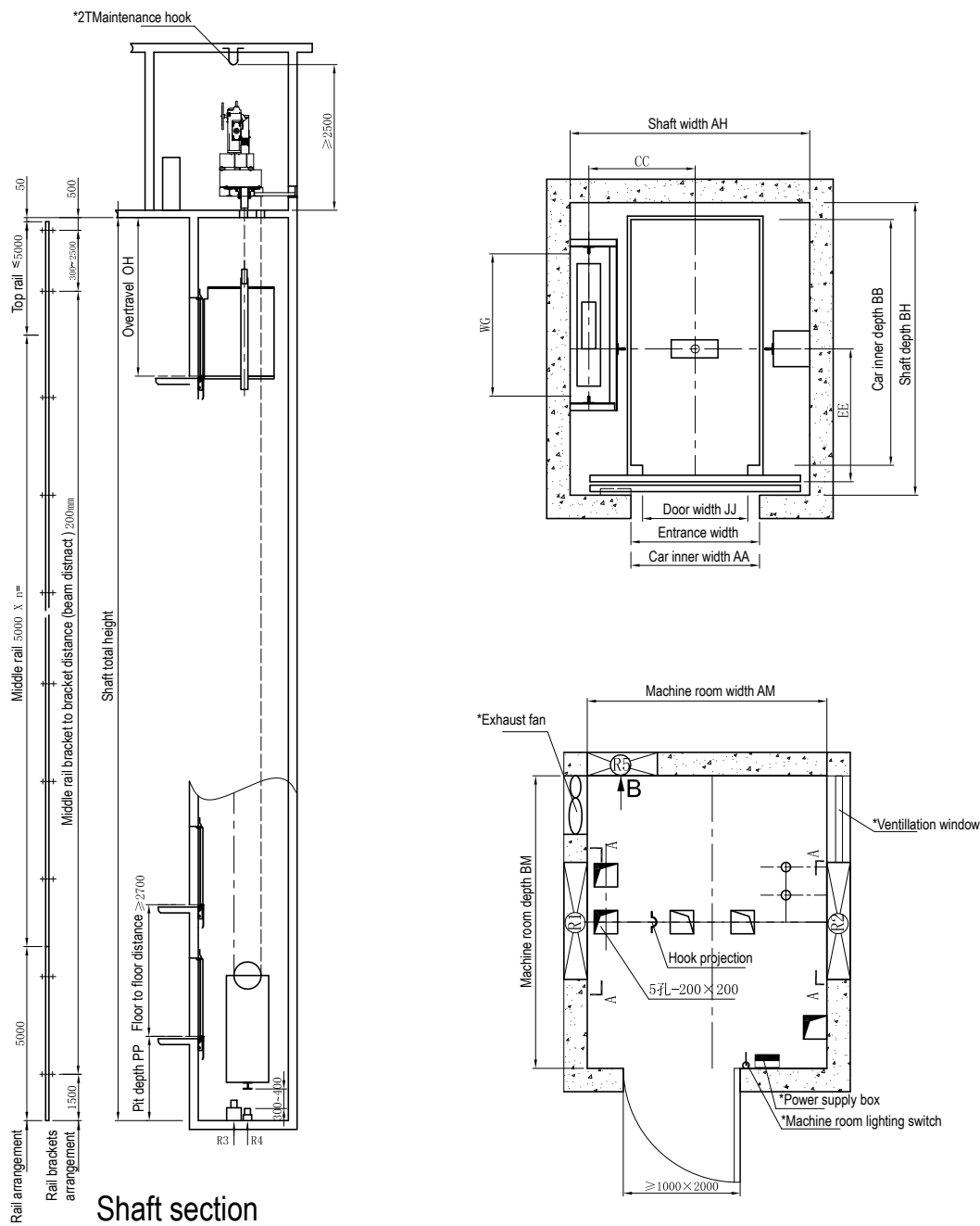

SL6000 rescue-use lift model & specification

Model	Speed m/s	Load kg	Door opening width JJ	Door opening depth	Car size AAxBB	Shaft size AHxBH	MR size AMxBM	Pit depth PP	Overtravel OH	MR net height below hoisting hook HM
SL6000	1.0	800	800	950	1100x1800	2050x2300	2050x2300	1400	4200	2500
SL6000	1.5							1400	4300	2500
SL6000	1.75							1400	4400	2500
SL6000	2.0							1500	4800	2500
SL6000	2.5							1900	5000	2500
SL6000	1.0	1000	900	1050	1100x2100	2050x2500	2050x2500	1400	4200	2500
SL6000	1.5							1400	4300	2500
SL6000	1.75							1400	4400	2500
SL6000	2.0							1500	4800	2500
SL6000	2.5							1900	5000	2500

SL6000 Standard functions

A/N	Items	Functions
1	Absolute position control	Through the car positioning technology, the elevator does not fall off the floor control, to ensure the reliable operation of the elevator.
2	Standby energy saving	When no one takes the elevator, the elevator enters the standby state, except the call button is slightly bright, other parts of the whole elevator no longer consume power, standby power consumption is less than 50VA, when someone takes the elevator, the elevator immediately wakes up to resume normal use.
3	Selective collective control	Car inner floor selection command and landing floor call command, automatically select the signal consistent with the direction of the elevator, and respond to the automatic control function in turn.
4	Attendant operation	The driver control the elevator's floor selection, landing call response, door opening and closing, and gives priority to determining the elevator's running direction.
5	Door open automatically when power on	Every time the system is powered on, when the car located at the leveling area, the car door will automatically open.
6	Automatic closing delay	After the car door is fully opened, keep it open, and automatically close the door after a delay of 2-5 seconds.
7	Door holding time adjustable	According to the customer's using requirements, humanized adjustment delay closing time, convenient for passengers to enter and exit.
8	Door closing error & alarm	Motherboard output closing signal, after a certain period of time the door interlock is not closed, re-open the door and then close the door again, repeat 6 times and still not connected, then stop the lift to repair and given fault alarm.
9	Door interlock protection	Lift can run only afte all the landing door lock are closed. If the door interlock is disconnected or the landing door shakes during operation, the elevator will immediately enter the protection state.
10	Door open at destination floor	After the elevator is leveling, press the call button to open the door automatically.
11	Press close button and the door close in advane	In the automatic state of early closing, while keeping the state open, press the close button to make the door close immediately and close the door in advance.
12	Destination floor door open automatically	When the elevator selects automatic operation, it automatically opens and closes the door every time it runs to the destination floor.
13	Maintenance operation	After the elevator enters the maintenance state, the elevator runs upward or downward at the maintenance speed to facilitate maintenance personnel.
14	Slow self-rescue operation	When the elevator is in the non-maintenance state, and not stop in the level area. At this time, as long as lift in the start-up safety requirements, the lift will automatically run at a slow speed to the level area, open the door and release people.
15	Shaft self-learning	Before the elevator runs at high speed, start the shaft learning function of the system, learn all kinds of data in the shaft (height, protection on/off position, deceleration switch position, etc.) and permanently save these operating data.
16	Hall call button block and self-diagnosis	If an hall call button is pressed for more than 20 seconds, the system considers the button blocked (cannot be reset), does not register the hall call, and the corresponding external display screen keeps flashing alarm.
17	Power-on self-recovery	Due to power off or power supply failure caused the car stopped between the two floors, when the power is recover, the car will automatically run to the level position and resume operation.
18	WDT Active protection	The main control board is equipped with WDT protection. When a CPU fault or program fault is detected, the WDT loop forcibly closes the output point of the main controller and resets the CPU.
19	Light curtain protection	Door Light curtain protection system at the door to form a light curtain protection safety net, touch the light curtain, the elevator closing action immediately stops, automatically open the door to protect the safety of passengers.
20	Overspeed protection	During the normal operation of the elevator, the controller detects that the feedback speed of the encoder is greater than 115% of the rated speed of the elevator, and this state is maintained for 500 milliseconds, and the elevator slows down and stops. After repeating the above action twice, if it is not corrected, the main controller will no longer output the operating signal and the fault alarm will be given.
21	Overload protection	Do not close the door when overloaded, overload light, buzzer, display overload information, the elevator does not start.
22	Reverse operation protection	Maintenance During operation, when the system detects that the direction of the elevator is inconsistent with the direction of the command within 3 seconds, it will stop immediately and give a fault alarm.
23	Car anti-skid door system	The elevator stops in the non-door area due to failure, and the car door is locked by the system to prevent passengers from pulling the door and protect passengers' safety.
24	Anti-skid protection	System through the AB phase encoder to detect the speed of the elevator, if in the actual time of the motor running speed and car running speed is not consistent, that is judged as wire rope skid, immediately stop the brake, and enter the 5 fault state.
25	Terminal floor protection	When the elevator runs to the floor terminal, if the deceleration does not reach the predetermined value, the system will force the deceleration to protect the safe operation of the elevator.



## SL6000 Standard functions

A/N	Items	Functions
26	Contactor contact detection protection	System to detect the motor loop contactor action is reliable, if found abnormal, will stop the elevator into the fault protection state, and give the precise fault type.
27	Safety circuit to protect	Any part of the elevator failure, the safety circuit is disconnected, the elevator will stop running immediately.
28	Operation timeout protection	When the elevator running time exceeds the total running time of the floor, the elevator will automatically stop the elevator fault alarm.
29	Limit protection	System detects the limit switch action, it will immediately stop the elevator operation, and then run in the opposite direction, and resume operation after leveling and door opened.
30	Terminal protection	When the system detects the limit switch action, the whole system enters the protection state immediately.
31	Brake detection protection	Real-time detection of brake opening and closing state, when the brake does not open according to the action requirements, the system will prohibit the elevator to start.
32	Inverter detection protection	Once system receives the inverter fault signal and lift will stop as emergency, and prevent the elevator from running
33	Encoder signal loss rotection	when there is a fault, and automatically resume operation when the fault is recovered.
34	Elevator sliding alarm	During the operation of the elevator, the encoder signal loss or pulse number is detected, automatic stop protection.
		System detects that when the elevator stops, there is a feedback pulse for 3 seconds, and it determines that the elevator has a sliding fault and give alarm.
35	Automatic stop when fault	When the elevator is running fast, the fault occurs and stops in the non-leveling area. If system safety loop still normally, the elevator will travels slowly to the levelliing position and open the door.
36	Full load by pass	When the elevator reaches the rated load, it only responds to the internal selection and does not respond to the landing call.
37	Anti-nuisance	In order to avoid the operation of the empty car, through the logical judgment of the load weight, the abnormal command is cancelled to avoid evil drama and wrong commands in the car.
38	Non-served floor setting	Can be set according to the actual requirements of customers, the non-served floor(s), And then the lift does not stop at those floors during travelling.
39	Floor lock out	After this function is activated, the elevator will respond to previosely registered commands and return to the designated floor. At the same time, enter into the energy-saving mode, the lighting inside the car will be cut off and the locking switch indicator light will be lit.
40	Floor-change and stop	If lift door locak not disconnection after door open trying 8 times, lift will leveling at nearest floor and release the passengers.
41	Automatic return to the base floor	When system not received any call or give any instructions within the preset time, the car will home to the base station, closes the door and standby.
42	Five-party communication	Can realize voice contact or seek help with the machine room, car top, the pit and the monitoring center through the intercom device on the car control panel. (The cable and laying from the machine room to the monitoring center shall be the responsibility by the user).
43	Power failure and emergency lighting	An emergency lighting device is installed in the car, and the emergency lighting will be automatically activated in case of power failure.
44	Emegency electrical operation	When the safety circuit fails, take an emergency measure (short-circuit part of the safety circuit) in order to release the people trapped in the car in the shortest time and restore the normal use of the elevator.
45	Text LCD display	The car is equipped with an text LCD screen, which clearly displays the floor information and elevator operation status.
46	eCloud	Integrates real-time monitoring of elevator operation, elevator event prediction and warning, remote diagnosis and elevator operation big data analysis, and fully builds elevator cloud security solutions.
47	Car unintendant movement protection	In the unlocked area and open state, when the car leaves the landing without instructions (excluding the movement caused by loading and unloading), the elevator will stop running immediately.

## SL6000 Optional functions

A/N	Items	Functions
1	Door pre-opening	When the elevator reaches the leveling area of the destination floor in normal operation, idle when running at low speed in the gate area; Effectively improve operation efficiency.
2	Deuplex control	When there is an landing call signal, two elevators can respond at the same time, according to their respective positions and operating directions in accordance with the principle of fast and energy-saving judgment, so that one of the elevators responds, thereby improving the efficiency of elevator operation.
3	Group control	Centralized control of more than two elevators, the system can achieve a maximum of eight elevators with group control, in the group control system, the elevator group can automatically select the most appropriate response, avoid repeated elevator stop, shorten the waiting time of passengers, improve operation efficiency, save electric energy.
4	Light curtain & Safety edge door rotection	Safety edge and light curtain protection - dual protection, when touching any device of light curtain or safety edge, the elevator door closing action immediately stops, automatic door opening, with photoelectric and mechanical dual protection functions.
5	Car protection plate	During the elevator installation or household decoration, the protection plate is installed in the car to prevent the car wall from being injured, and the elevator can be removed when it is used normally.
6	ARD( automatically rescue device)	In case of power failure, automatically switch on the standby power supply, according to the set program to run slowly to the nearest floor, open the door to achieve emergency rescue.
7	Camera monitoring system interface reservation (car monitoring)	Reserved monitoring interface, easy to achieve elevator video monitoring. (Monitoring equipment, cables from the equipment room to the monitoring center, and laying them are the responsibility of the user.
8	Energy regeneration	When the elevator goes down, the potential energy is converted into electric energy, and the generated direct current is converted into electric energy consistent with the voltage of the power grid through rectification, which is fed back to the power grid for the use of other electrical equipment nearby to achieve energy saving effect.
9	Voice announcement	Remind passengers in the car or waiting for passengers outside the hall of the elevator to the station floor and the corresponding floor information.
10	Hall lantern	Install arrival lights outside the landing according to customer needs to remind passengers waiting outside the hall, the elevator's arrival and running direction.
11	Earthquake control	Once appear earthquake, and lift received the alarm signals, will leveling at nearest floor and release the passengers.
12	Special air conditioning	Elevators can be equipped with special air conditioning for elevators to improve the car environment.
13	Timing switch	Can set the opening and closing time automaticly.
14	Building monitoring interface	Provides elevator operating status signals for building intelligent management system.
15	Car cage IC Card	When the car IC card service is equipped with this function, there is a card reader on the car control panel, and passengers must swipe the card before they can register to use the elevator.
16	Landing IC card	When the landing equipped with this function, passengers must swipe their card before entering the car.
17	Negative oxygen ion device	Adding negative oxygen ions can improve the air quality in the car.
18	Arrival gone	Warning function During the elevator deceleration level, the arrival bell will ring to remind passengers in the car or passengers waiting outside the landing that the elevator is on the level.

Once more information required, please contact with us!



The information and graphics in this brochure reflect the technical characteristics and configuration of elevator models as of the deadline (see back cover version number). In line with the principle of continuous development of products, our company reserves the right to change the technical parameters, selection and color of products at any time, and the existing shooting technology and digital simulation technology can not accurately reproduce the color of elevator components, structure and decoration, therefore the rendering is for reference only, and everything is subject to the supply. This brochure only provides general information, not as a contract document, the specific configuration parameters shall be subject to the formal contract agreement. If you need to know more information, please contact our company.



## XJ Schindler Elevator Co Ltd

Address: 2120 Yan 'an South Road, Xuchang Economic and Technological  
Development Zone, Henan Province, China  
Tel: +86 400 811 6869 Website: [www.xjschindler.com](http://www.xjschindler.com)